



RB-GROUP





RB-DOORS

Commercial



Institutional Formica Door

Leaf thickness – 43.6mm

Max Wall Opening Measures: 1200X2350mm

Vision Panel Dimensions (optional):

600x200 mm

Round 490 mm diameter

Construction frame made of 1.5 galvanized steel

Options:

- Double leaf
- Hydraulic door closer
- Panic bar
- Panic lock
- Fixed handle
- Roll Lock
- Louver option

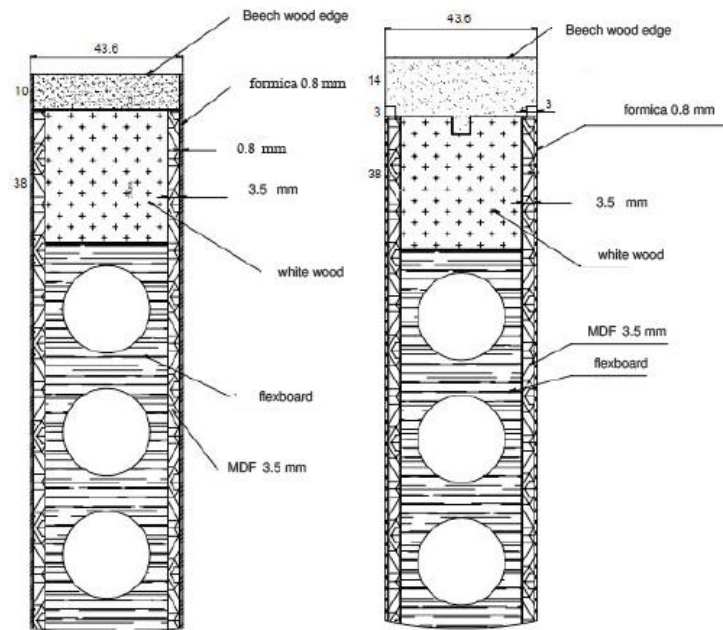

window types

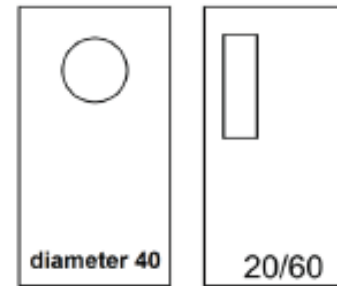

Model 740 – Security Entrance Door (Acoustic 30Db)

GENERAL DESCRIPTION

The Residential security steel door is made of two 1.25 mm thick galvanized steel sheets with vertical and horizontal steel bars placed between the sheets, reinforcing the door leaf for optimum security structure. Door leaf thickness is 50 mm.

Acoustic 30Db.

The door filling: polystyrene foam, cardboard honeycomb or rock wool.

Peripheral rubber seal.

Telescopic bottom insert for easy door height adjustment.

Door leaf weight is ~50kg.

LOCKING SYSTEM

The door is equipped with a unique 3-way lock with four 10 mm front bolts.

The lock also activates upper 13 mm bolt, and 1 unique hook mechanisms, located below the main lock.

1 fixed hook bolt in the hinge side.

High security RB cylinder.

An improved cylinder protector preventing picking and drilling as well as forcing of the lock cylinder.

FRAME

Construction frame made of 1.5 mm thick galvanized steel. The frame with anchors is mounted and cemented directly into the wall.

Cover frame made of 1.25 mm thick steel for installation on existing wood or metallic frames.

DOOR FINISHES

PVC finish.

Electro-static powder coating.

DIMENSIONS

Max Door Height – 2,900 mm

Max Door Width – 1,280 mm (single leaf).

Door is available in Single or Double - leaf variants.



Upper Bolt



Multi-Point Lock with Bolts



Geometric Hook Locking Mechanism



Fixed Bolt



Telescopic Bottom Insert (optional)

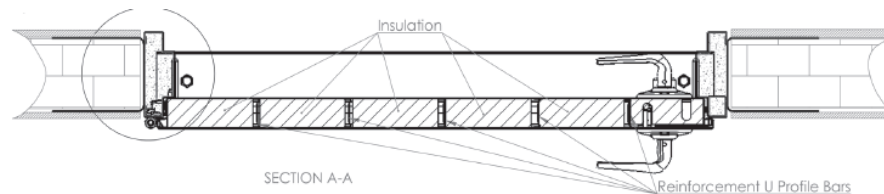
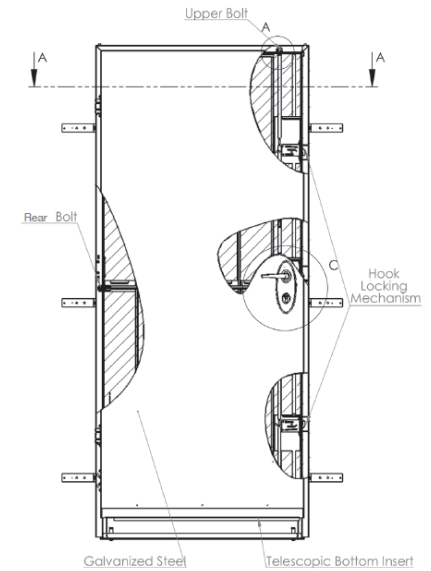

<https://www.youtube.com/watch?v=P3G7c61YsP0>

Model 850 – Security Entrance Door with Gladiator System (Acoustic 30Db)

GENERAL DESCRIPTION

The Residential security steel door is made of two 1.25 mm thick galvanized steel sheets with vertical and horizontal steel bars placed between the sheets, reinforcing the door leaf for optimum security structure. Door leaf thickness is 50 mm. Acoustic 30Db. The door filling: polystyrene foam, cardboard honeycomb or rock wool. Peripheral rubber seal. Telescopic bottom insert for easy door height adjustment. Door leaf weight is ~50kg.

LOCKING SYSTEM

The door is equipped with a unique 3-way lock with four 10 mm front bolts. The lock also activates upper 13 mm bolt, and 3 unique hook mechanisms, located above and below the main lock. 3 fixed hook bolts in the hinge side are attaching the door leaf to the frame applying high security structure. High security RB cylinder. An improved cylinder protector, preventing picking and drilling as well as forcing of the lock cylinder. In a locked position, geometric locking is achieved. The bolts are independent which means that forcing one bolt will not affect the others and will not cause the opening of the lock system by pushing or applying pressure on a bolt head.

FRAME

Construction frame made of 1.5 mm thick galvanized steel. The frame with anchors is mounted and cemented directly into the wall. Cover frame made of 1.25 mm thick steel for installation on existing wood or metallic frames.

DOOR FINISHES

PVC finish.
Electro-static powder coating.

DIMENSIONS

Max Door Height – 2,900 mm
Max Door Width – 1,280 mm (single leaf).
Door is available in Single or Double - leaf variants.



Upper Bolt

Geometric Hook Locking Mechanism

Multi-Point Lock with Bolts

Geometric Hook Locking Mechanism

Telescopic Bottom Insert (optional)

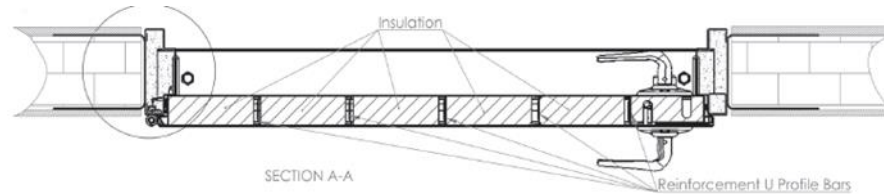
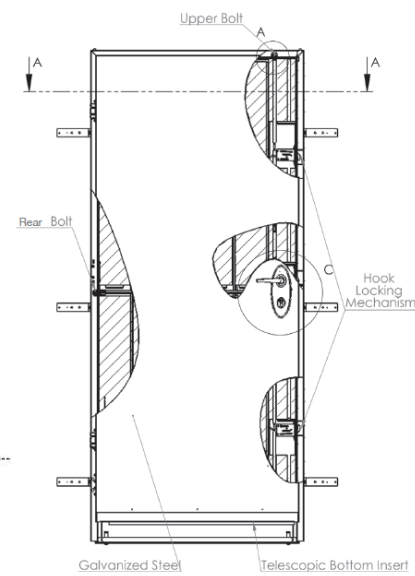

<https://www.youtube.com/watch?v=P3G7c61YsP0>

FE5 – Force Entry Door (High Security Standard)

GENERAL DESCRIPTION

- The door leaf is constructed of two galvanized steel sheets (thickness 1.25mm) together with 0.8 hardened steel plate attached to the sheet.
- The door leaf is reinforced by horizontal and vertical steel bars which together with the casing, create a high security structure.
- Five Hook type locking mechanisms and four fixed rear security bolts.
- Four concealed hinges.
- Four way mortise lock.
- Door leaf thickness: 50mm.
- The door leaf is pre-hung to the frame.
- Door leaf weight ~ 80 kg.
- Outward opening door only.

HARDWARE AND ACCESSORIES

- RB High security cylinder.
- Hardened drill resistant cylinder protector with a rotating disc.
- Security cover plates on both sides of the locking case.
- Four way mortise lock as standard and Electronic monitoring function (lock \ un-lock) – optional.
- Motorized cylinder with mechanic back-up - optional.

FRAME

- Construction or Cover special FE5 frame.

DOOR FINISHES

- PVC finish.
- Powder coating.
- 4 mm decorative panels.

DIMENSIONS

- Door Height: 1,960 – 2,370 mm.
- Door width: 700-1,100 mm.

*Double door is available in custom made orders.

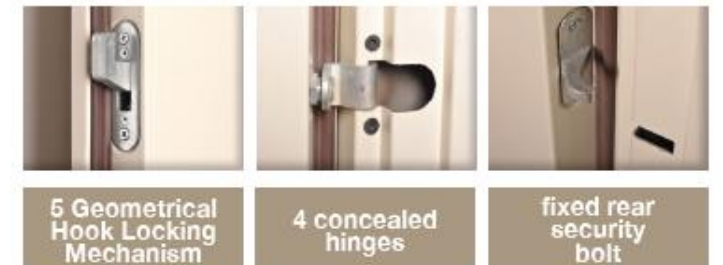

FE15 – Force Entry Door (High Security Standard)

GENERAL DESCRIPTION

- The door leaf is constructed of two galvanized steel sheets (thickness 1.25mm) together with 0.8 hardened steel plate attached to the sheet.
- The door leaf is reinforced by horizontal and vertical steel bars which together with the casing, create a high security structure.
- Five Hook type locking mechanisms and four fixed rear security bolts.
- Four concealed hinges.
- Four way mortise lock.
- Door leaf thickness: 50mm.
- The door leaf is pre-hung to the frame.
- Door leaf weight ~ 80 kg.
- Outward opening door only.
- Available in UL 60 min. fire rating according to UL10b

HARDWARE AND ACCESSORIES

- RB High security cylinder.
- Hardened drill resistant cylinder protector with a rotating disc.
- Security cover plates on both sides of the locking case.
- Four way mortise lock as standard and Electronic monitoring function (lock \ un-lock) – optional.
- Motorized cylinder with mechanic back-up - optional.

FRAME

- Construction or Cover special FE15 frame.

DOOR FINISHES

- PVC finish.
- Powder coating.
- 4 mm decorative panels.

DIMENSIONS

- Door Height: 1,960 – 2,370 mm.
- Door width: 700-1,100 mm.

*Double door is available in custom made orders.

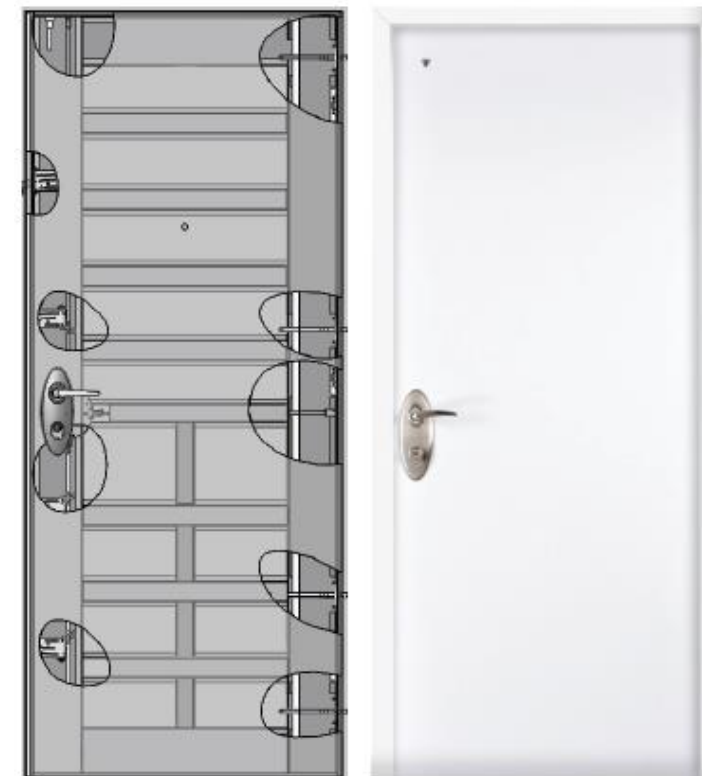

Model 769 - Bullet Resistance Door

GENERAL DESCRIPTION

The door is made of two 1.25mm thick galvanized steel sheets, reinforced by horizontal steel bars set between the casing and the armor plate.

RB's High security 4-way locking system with additional reinforcement mechanism, 4 heavy duty hinges, Telescopic bottom insert for door height adjustment.

Door leaf thickness is 50 mm.

Door weight is 120 kg - 150 kg.

*Bullet resistant window - optional.

CERTIFICATION

Ballistic resistant armor steel plate, tested according to UL 752 protection level 4-8 and EN1503.

Ballistic resistant transparency tested according to DIN 52290 part 2, using an AK- 47 and M16.

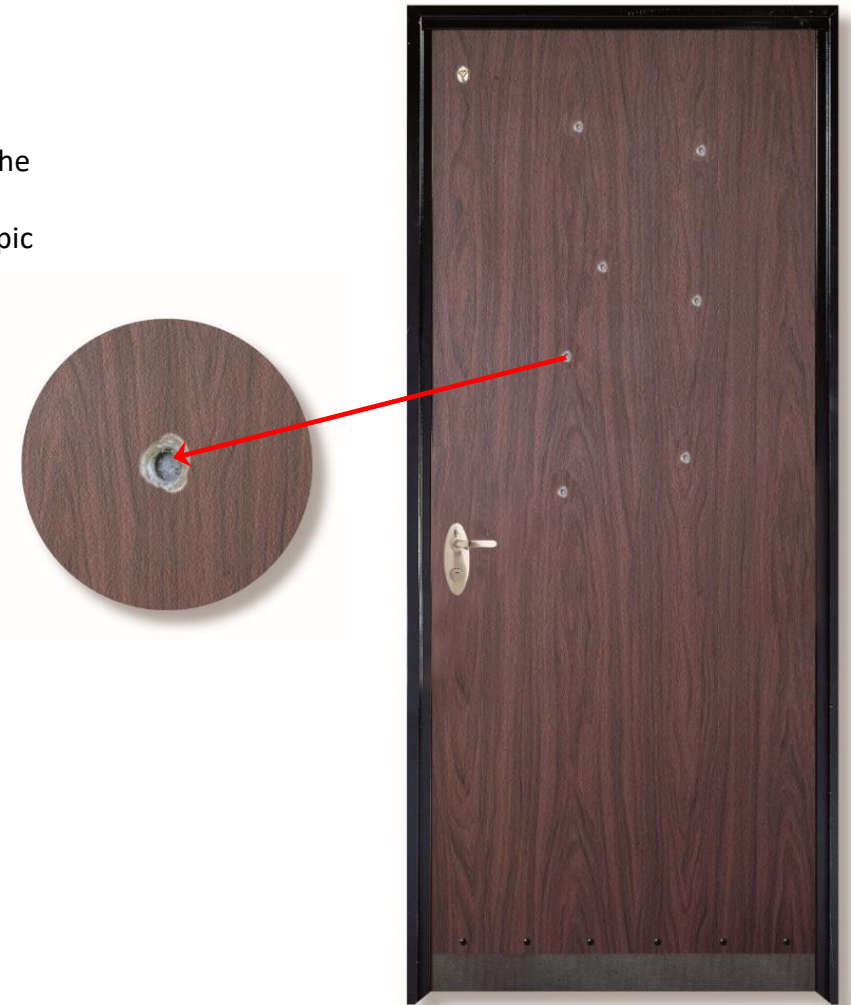

FWB – Fire Rated Door 60 min

GENERAL DESCRIPTION

Door leaf with two 1.25 mm thickness galvanized steel casings and interior reinforcements.

Intumescent gasket between door and frame.

Fire rated hardware.

Telescopic bottom insert for final height adjustment.

HARDWARE AND ACCESSORIES

Fire rated lock.

Moveable lever door handles.

Fixed handle – optional.

Hydraulic closer - optional.

WINDOW DIMENSIONS (OPTIONAL)

600x400 mm.

820x240 mm.

Round 440 mm diameter.

DOOR FINISH

PVC finish.

Electro-static powder coating.

DIMENSIONS

Maximum door leaf height: 2470 mm.

Maximum door leaf width: 1120 mm.

Maximum frame dimensions: 2600X1200 mm.



FW30/FW60/FW90 - Fire Rated Door 30/60/90 min

GENERAL DESCRIPTION

Door leaf with two 1.25 mm thick galvanized steel casings and interior reinforcements.

Intumescent gasket between door and frame.

Fire rated hardware.

Telescopic bottom insert for final height adjustment.

HARDWARE AND ACCESSORIES

Panic Lock.

Moveable lever door handles.

Fixed handle, Panic bar or Push bar – optional.

Hydraulic closer - optional.

Door closing coordinator - for double door.

WINDOW DIMENSIONS (OPTIONAL)

600x400 mm.

820x240 mm.

Round 440 mm diameter.

DOOR FINISH

PVC finish.

Electro-static powder coating.

DIMENSIONS

Maximum door leaf height (without bottom insert) – 2200 mm.

Maximum door frame height – 2400 mm.

Maximum moveable door width – 1140 mm.

Maximum fixed door width – 1140 mm.

Maximum double-leaf door frame width – 2360 mm.



FW120 – Fire Rated Door 120 min. (South African Standard)

GENERAL DESCRIPTION

The door leaf is made of two 1.25 mm galvanized steel sheets, reinforced by an internal profile structure. There are no welding points on the door - increased corrosion resistance.

The door is equipped with a telescopic bottom insert for door height adjustment.

Double layered door leaf filling - high density rock wool and fire resistant gypsum.

Peripheral fire and smoke resistant gasket with intumescent core is attached to the door leaf edge.

Door leaf thickness is 50 mm.

HARDWARE AND ACCESSORIES

Available with stainless steel fixed handle, or with moveable handles.

Door closer - optional.

Anti - Panic lock.

Door coordinator for double leaf door – optional.

Panic bar - optional.

WINDOW DIMENSIONS (OPTIONAL)

600x400 mm.

820x240 mm.

Round 440 mm diameter.

DOOR FINISH

PVC finish.

Electro-static powder coating.

DIMENSIONS

Maximum door leaf height (insert height not included) – 2,400 mm.

Maximum door frame height – 2,500 mm.

Maximum moveable door width – 1,300 mm.

Maximum fixed door width – 1,300 mm.

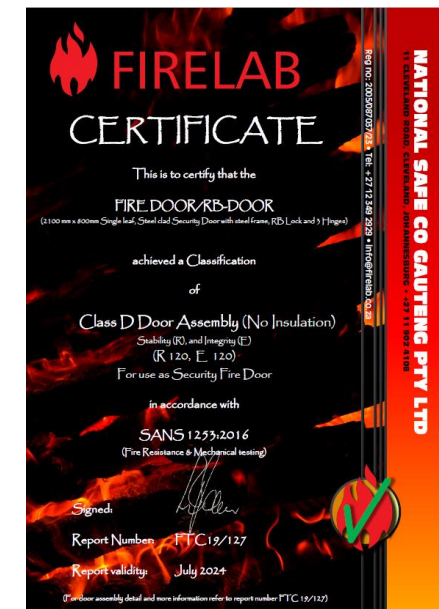

FW31AC/FW91AC - Acoustic Fire Rated Door 30 min (34DB) /90 min. (41DB Single, 38DB Double)

GENERAL DESCRIPTION

The door leaf is made of two 1.25 mm galvanized steel sheets, reinforced by an internal profile structure.

The door is equipped with a telescopic bottom insert for door height adjustment.

Double layered door leaf filling - high density rock wool and fire resistant gypsum.

Peripheral fire and smoke resistant gasket with intumescent core is attached to the door leaf edge.

Door leaf thickness is 50 mm.

HARDWARE AND ACCESSORIES

Available with stainless steel fixed handle, or with moveable handles.

Door closer - optional.

Anti - Panic lock.

Door coordinator for double leaf door - optional.

Panic bar - optional.

WINDOW DIMENSIONS (OPTIONAL)

600x400 mm.

820x240 mm.

Round 440 mm diameter.

DOOR FINISH

PVC finish.

Electro-static powder coating.

DIMENSIONS

Maximum door leaf height (insert height not included) - 2,400 mm.

Maximum door frame height - 2,500 mm.

Maximum moveable door width - 1,300 mm.

Maximum fixed door width - 1,300 mm.

Acoustic rating for FW30 door with Acoustic Frame - 34DB

Acoustic rating for FW90 door with Acoustic Frame: Double door - 38 DB*, Single door - 41 DB*

*Weighted sound reduction index - Rw



FW870/870S – Electro-Mechanic Controlled Fire Rated Door 60 min

General Description

- The door leaf is made of two 1.25 mm galvanized steel sheets, reinforced
- by an internal profile structure
- The door is equipped with a telescopic bottom insert for door height adjustment.
- Double layered door leaf filling - high density rock wool and fire resistant gypsum.
- Peripheral fire and smoke resistant gasket with intumescent core is attached to the door leaf edge.
- Door leaf thickness is 50 mm.
- Fire rated 60 min.

Hardware and Accessories

- FWI 870S - Slammed & locked panic mechanic lock, fixed external handle, moving internal handle
- FWI 876S - Slammed & locked panic electro-mechanic lock, moving external handle, moving internal handle, in case of power outage the lock is closed from external side (fail secure)
- FWI 879S - Slammed & locked panic electro-mechanic lock, fixed external handle, moving internal handle, in case of power outage the lock is opened from external side (fail safe)
- Emergency opening by cylinder
- Optional panic bar (push bar or touch bar)
- Door closer
- Black fire moving handle
- Heavy duty Pipe hinges

**BKS Multipoint Slammed
& Locked Electro-
Mechanic Lock**



**BKS Slammed & Locked
Electro-Mechanic Lock**



FW730/FW760/FW765 – Fire Rated Door 30/60/90 min with Butt Hinges (non-rebate)

**Fire Black
Moving Handle**



**Heavy Duty
Butt Hinges**



ISEO Panic Lock



Door Closer



FW770 – Electro-Mechanic Controlled Fire Rated Door 90 min with Butt Hinges (non-rebate)

**Fire Black
Moving Handle**



**Heavy Duty
Butt Hinges**



**BKS Slammed&Locked
Electro-Mechanic Lock**



Door Closer



Fire Doors Accessories



ISEO Push Bar



Door Closer



3 Pipe Hinges



**BKS Slammed & Locked
Electro-Mechanic Lock**



ISEO Touch Bar



ISEO 72 Touch Bar



ISEO 72 Push Bar



**Stainless Steel
Moving Handle**

Auto Door Opening Function

**Fixed external handle,
moving internal handle**



Push Button



Automatic Door Opening



Steel Storeroom & Industrial Doors – 450 Series

GENERAL DESCRIPTION

Steel door made of 1.25/0.8 mm galvanized steel casings, with or without a surrounding rubber seal on edges and telescopic bottom insert for easy door height adjustment. Suitable for storerooms, ventilation rooms, electric rooms and general facilities.

DOOR LEAF DIMENSIONS MODELS 452 & 451

Width: from 880 to 1280 mm in increments of 20 mm
Height: ranging from 1820 mm and up to 2800 mm (not including insert height)

DOOR LEAF DIMENSIONS MODELS 456 & 455

Width: from 300 to 860 mm in increments of 20 mm
Height: ranging from 1820 mm and up to 2800 mm (not including insert height)

OPENING DIRECTIONS

Right/left
Outwards/inwards opening

WINDOW OPTIONS

Smoke Shutter Window (upper/lower/entire door/upper and lower)
Vent slats (louver) (upper/lower/ entire door/upper and lower)

LEAF INSERT

Standard height: 105 mm, 130 mm height by special order

FINISHES

Textured or granular Electrostatic Paint Finish according to RB color catalogue
PVC Finish
Galvanized

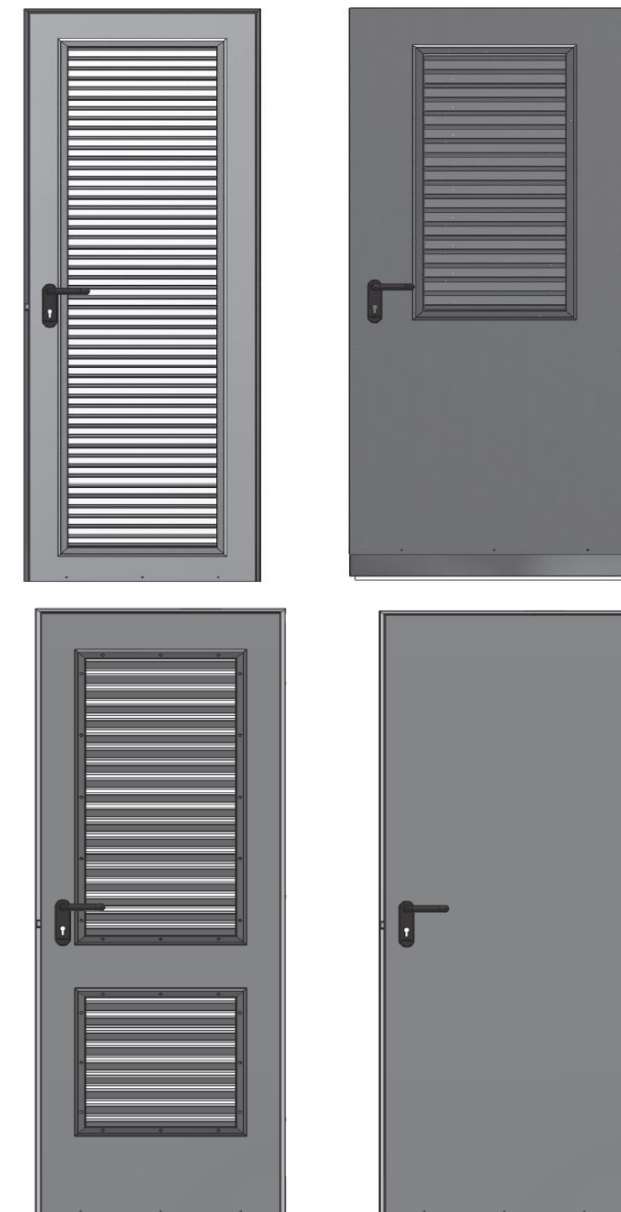

Louvers

- Made of 1.5mm galvanized steel
- Custom made per required measures
- Including frame for perfect fit
- Max. dimensions for painted louver 1500/2500mm
- Larger dimensions available as galvanized only

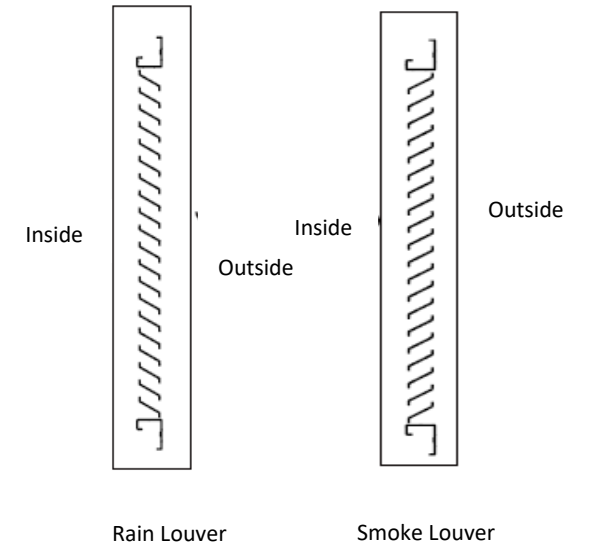
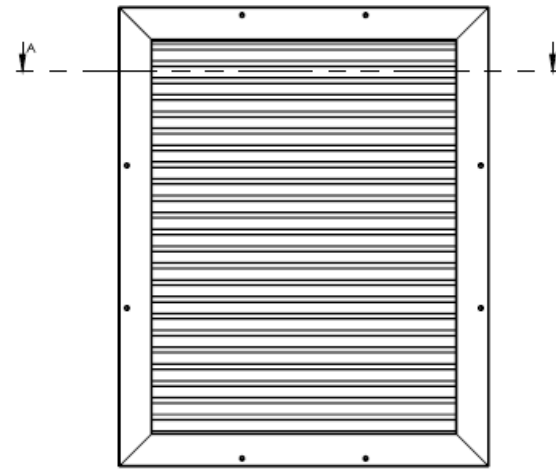

Frames

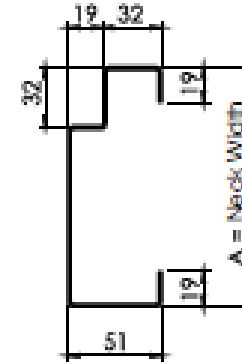
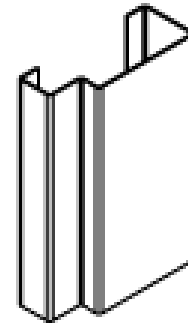
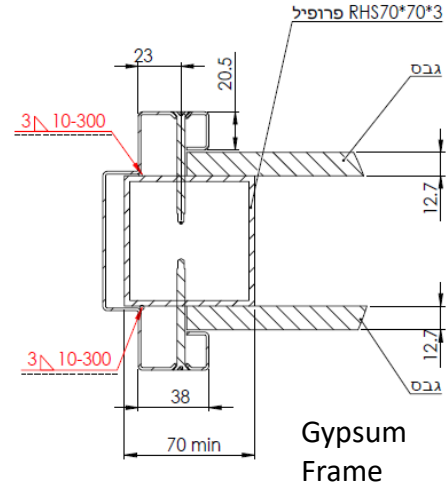

Construction Frame

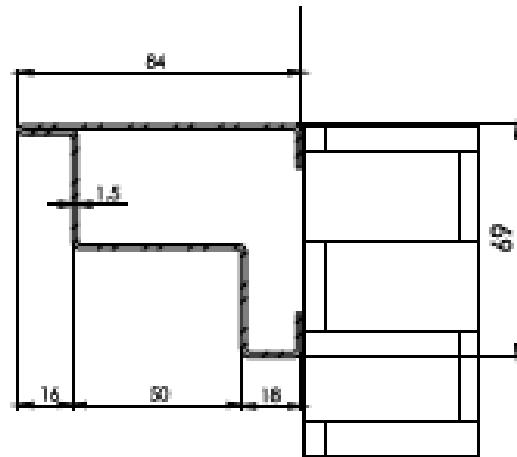

Flush Finish Frame

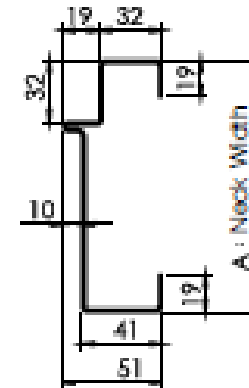
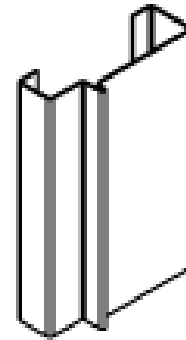

New Construction Frame
Artistic Cladding

Roller Shutter Model 3000

Technical Specification

The Door

The door is made of double wall galvanized and painted steel bars (0.4mm thickness), connected to each other and create smooth surface. The bars are filled with foamed Polyurethane.

Lifting Mechanism

The shutter is rolled up on cylinder made out of thick steel tube and customized to door width and weight. There are two reinforced clips made of steel attached to the wall.

Door Leader

The door leaders made of G shape galvanized steel (3mm thickness) insuring smooth and quiet operation.

Bottom Sealing Rubber

The bottom bar made of aluminum and including sealing rubber for complete seal for noise and dust.

Steel Thickness	0.4mm
Bar Thickness	23mm
Bar Weight per SQM	10Kg
Filling Material	Foamed Polyurethane
Coefficient of thermal insulation	U = 3.47 W
Window Dimensions	50x100mm
Louver Dimensions	50x100mm
Max. Width	8000mm
Track Thickness	3mm
Track Weight per SQM	5Kg
Track Dimensions	80x78.6x80mm

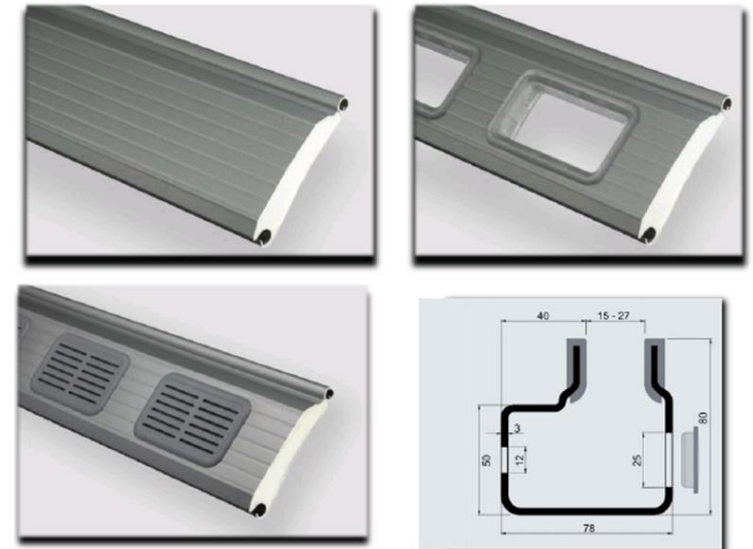
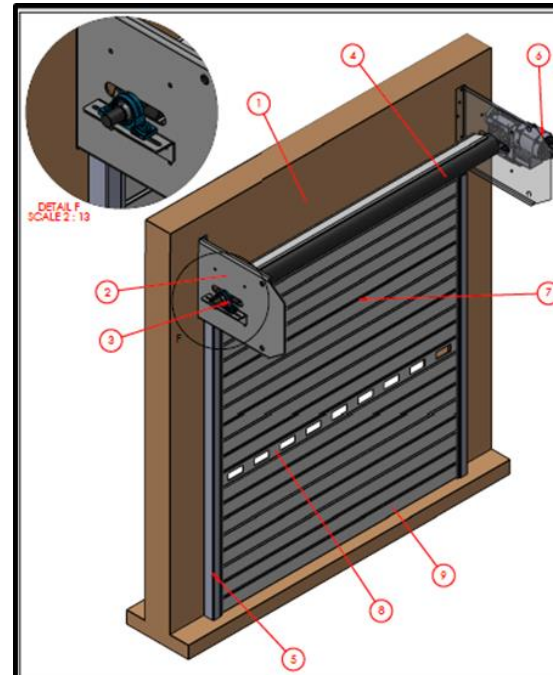

Acoustic Roller Shutter Model 1000AC (25Db)

Technical Specification

The Door

The door is made of double wall galvanized and painted steel bars (0.4mm thickness), connected to each other and create smooth surface. The bars are filled with high density Rockwool.

Lifting Mechanism

The shutter is rolled up on cylinder made out of thick steel tube and customized to door width and weight. There are two reinforced clips made of steel attached to the wall.

Door Leader

The door leaders made of G shape galvanized steel (3mm thickness) insuring smooth and quiet operation.

Bottom Sealing Rubber

The bottom bar made of aluminum and including sealing rubber for complete seal for noise and dust.

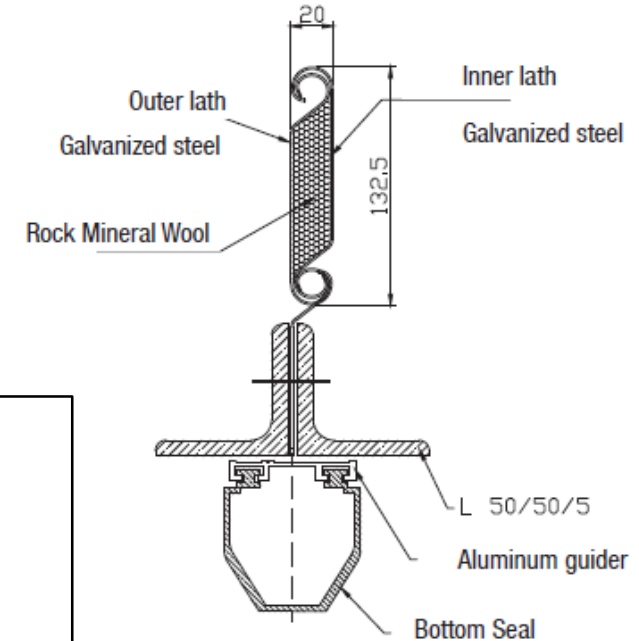

Insulated Overhead Roller Door
Model: Pazgal 1000AC
Pazgal Ltd., from the RB-Group

Determining Weighted Index for Airborne Sound Insulation
according to:

ISO 10140-2 Standard

Report Number: 1183-5

Client	Rav Bariach Ltd
Address	31 Ha-Ofeh St. South Industrial Zone, POB 3032, Ashkelon, 78780
Manufacturer	Pazgal- from the RB Group
Address	20 Alon HaTavor St., Caesarea Industrial Park
Facility Engineer	Eng. David Freid
Date of Report	19.06.2014
Date of Measurement	06.16.2014
Number of Pages	12
Text	6
Appendix A	1
Appendix B	3
Appendix C	2

Fire Resistant Roller Shutter Model 501

General Information

- The shutter is constructed from interlocked, baked painted galvanized steel laths which form a sealed curtain. The shutter winds back on a horizontal steel shaft tensioned by torsion springs.
- The shutter is electrically operated and includes a reserve chain for manual operation.
- Edge fasteners made from cast steel are attached to the edges of the laths and fitted into the curtain guides.
- Bottom edge of curtain- double steel angle for increased resistance at the bottom of the curtain.
- Upper Hinge Fasteners- made from thick-walled steel fitted with bearings matching the size of the door.
- Guides for the curtain made from 3- thick-walled steel angles forming a rail set apart from the wall. At the top edge- a stopper for stopping the door at the bordering point of the light opening.
- Above the drum- cylindrical steel protective cover made from 0.6 mm galvanized steel.

Method of Operation

- The fire-resistant shutter automatically shuts in the event of fire.
- The torsion springs are under tension and are connected to a chain anchored to the wall, with one of the links being a multi-use electronic fuse that melts at a temperature of 70°C. The detachment releases part of the spring's action and the curtain drops in a controlled manner, closing the opening.
- Operation- Electrically operated via a three-phase motor with suitable power supply corresponding to the size of the shutter, with a reserve chain for manual operation included.
- Automatic stopper to prevent opening of the door from the outside (this unit serves as a lock in place of the existing lock).
- Control box for electrical operation by switches located on the wall, with operation buttons: up, down and stop.

Installation

The shutter is to be installed by a professional installer certified by the RB-Group and to be anchored to the frame of the opening according to RB-Group instructions.

Options

- Connection to the "Fireguard" Fire and Smoke Detection System
- Flashing light/buzzing alarm
- External operation box with key
- Advanced control box, for control of the door's operations and receipt of external commands
- Fail Safe option
- Color options for laths: standard- white RAL 9006



FIRE RATINGS

Test Standard	Rating
UL10 B	3 Hours Neutral Pressure

SIZE LIMITATIONS

Certification Procedure	Maximum Area	Maximum Width	Maximum Height
Label	5.52 Sq. M (59.4 Sq. ft)	2400 mm (7 ft 10-1/2 in)	2300mm (7ft 6-1/2 in)
Oversize Certificate*	Unlimited*	Unlimited*	Unlimited*

Force Entry 5/15 min. Roller Shutter

roller door profiles | single-walled

1.1620



Description

The roller door profile 1.1620 is the all-rounder among single wall roller door profiles as a result of the diversity of versions as window, grille and perforated plate profile and the wide selection of material types, strengths and surfaces. It meets the requirements for a classic, sturdy roller door in appearance and function and is frequently also used in doors that have to withstand frequent loading. The arched form permits relatively slight shaft and barrel diameters.

roller door profiles | double-walled

1.100 D



Description

The great stability, clear lines and a variety of versions make the 1.100 D roller door profile a popular classic.

Specialties include a suitable sealing lip profile, tests for sound and thermal insulation and gunfire protection for certain models and certification as a terrorism-protection roller door for one special model.

Also available with colored coating in all RAL-colors, with plastic coating like RAL 9002 and 9010 (aluminum 1.00 mm and 1.25 mm) and with coil coating like RAL 3000, 5010, 8017, 9006, 9016 (aluminum 1.00 mm).



Arm Barrier

- Electric arm barrier enabling quick and convenient entrance and exit for parking lot regulation and control
- Allowing entrance to authorized people and vehicles only
- Anti-collapse mechanism
- LED lightning
- Manual opening in case of emergency
- Remote control by phone/remote control/push button
- Integration to access control system
- Up to 6m long



Electro-Mechanical Solutions

RB delivers a wide variety of electro-mechanical solutions for different applications



Biometric Keypad
Control Unit



Biometric & Code
Handle



Electronic Cylinder

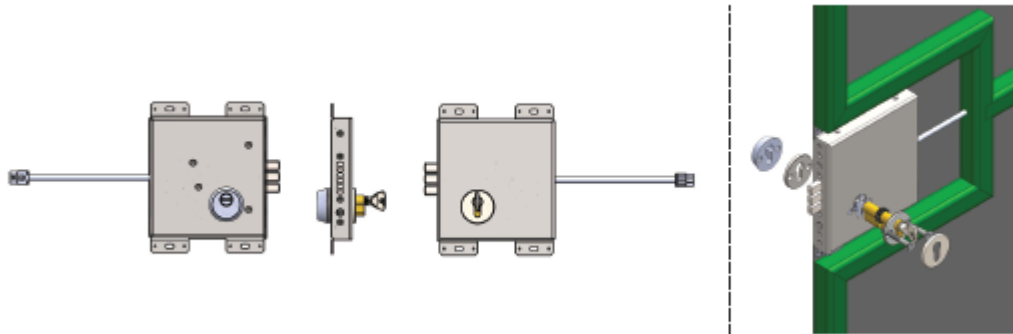

Retrofit Solution



RBM Electro-Mechanic
Lock